

PARKING BRAKE LEVER REMOVAL/INSTALLATION

B3E041244300W06

1. Remove the main silencer. (See [EXHAUST SYSTEM REMOVAL/INSTALLATION \[ZJ, Z6\]](#).) (See [EXHAUST SYSTEM REMOVAL/INSTALLATION \[LF\]](#).)
2. Remove the heat insulator.
3. Remove the console. (See [CONSOLE REMOVAL/INSTALLATION](#).)
4. Remove in the order indicated in the table.
5. Install in the reverse order of removal.
6. After installation, inspect the parking brake lever stroke. (See [PARKING BRAKE LEVER INSPECTION](#).)

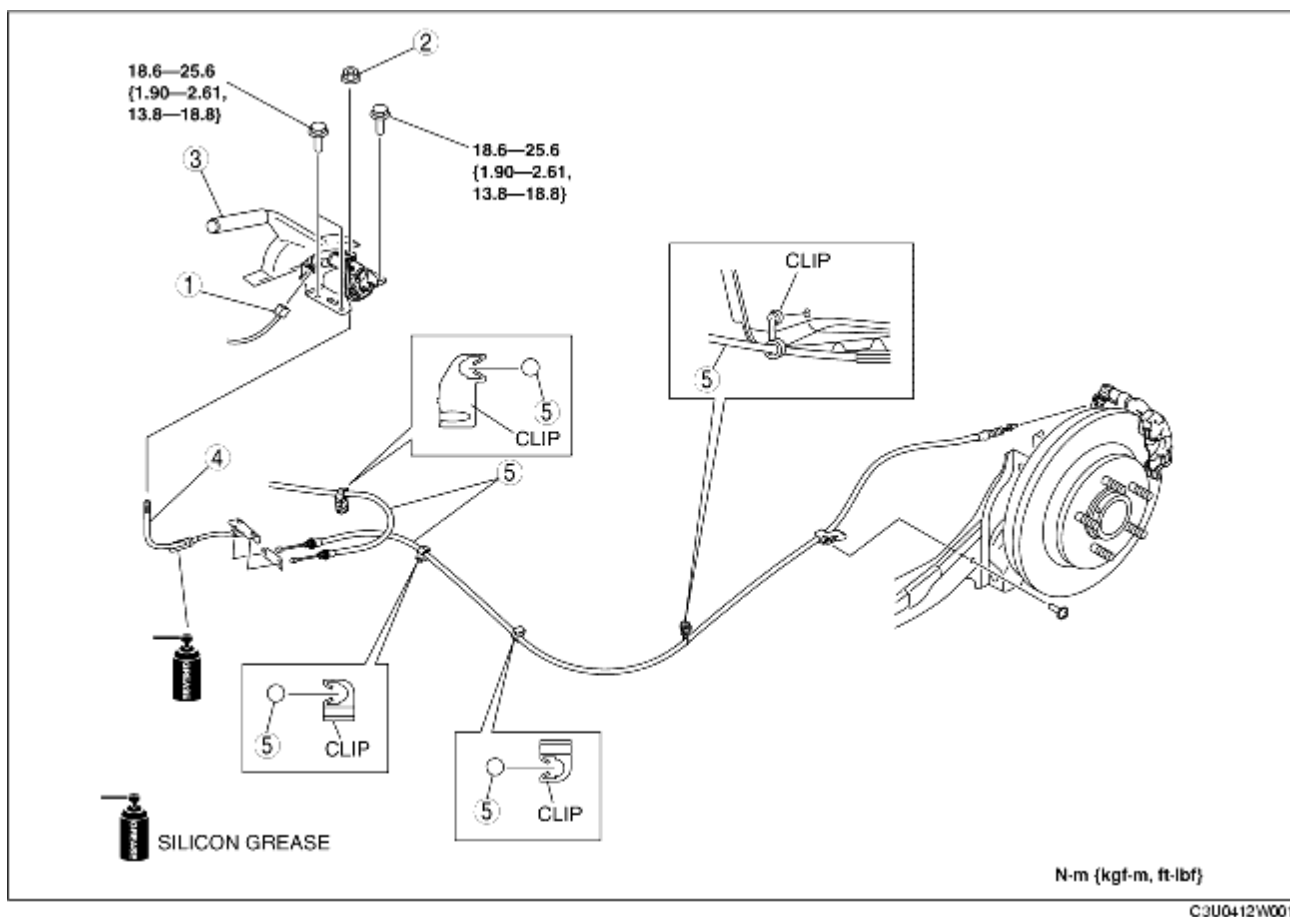

| | |
|---|--|
| 1 | Parking brake switch connector |
| 2 | Adjusting nut |
| 3 | Parking brake lever |
| 4 | Front parking brake cable (See Front Parking Brake Cable Installation Note .) |
| 5 | Rear parking brake cable |

|||(See [Rear Parking Brake Cable Installation Note.](#))|||

Rear Parking Brake Cable Installation Note

1. Pass the rear parking brake cable inside the rear ABS wheel-speed sensor wiring harness as shown in the figure.

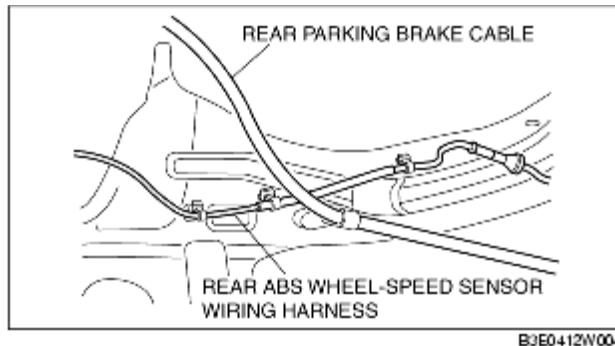

2. Install the rear parking brake cable.

Front Parking Brake Cable Installation Note

1. Install the front parking brake cable with the mark on the equalizer facing toward the vehicle downside.

